

# ANSI B 16.11

Hexagonal Nipples  
3000 / 6000 Lbs

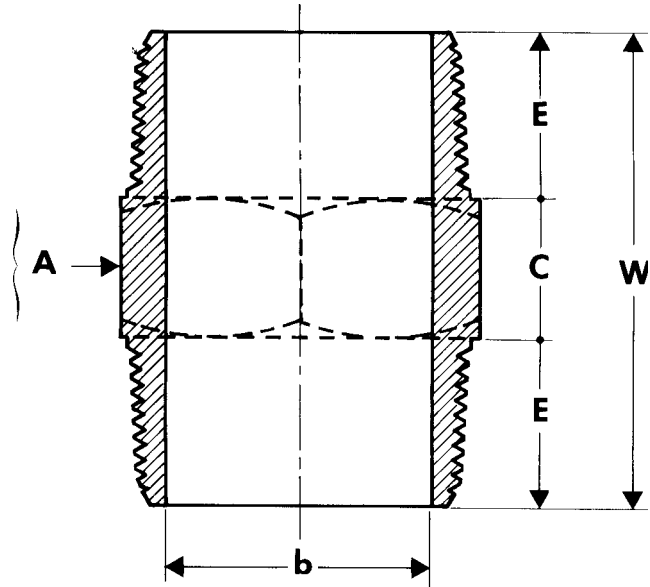

Nominal Size		A min.		E min.		C min.		W min.		B			
Inches	mm	mm	inch	mm	inch	mm	inch	mm	inch	3000		6000	
										mm	inch	mm	inch
1/8	6	11	0.43	10	0.39	6	0.24	26	1.02	5	0.20	2	0.08
1/4	8	15	0.59	15	0.59	6	0.24	36	1.42	8	0.31	6	0.24
3/8	10	18	0.71	16	0.63	8	0.31	40	1.57	11	0.43	8	0.31
1/2	15	22	0.87	20	0.79	8	0.31	48	1.89	14	0.55	11	0.43
3/4	20	27	1.06	21	0.83	10	0.39	52	2.05	19	0.75	13	0.51
1	25	35	1.38	25	0.98	10	0.39	60	2.36	24	0.94	17	0.67
1.1/2	40	50	1.97	26	1.02	16	0.63	68	2.68	38	1.50	30	1.18
2	50	62	2.44	27	1.06	17	0.67	71	2.80	49	1.93	39	1.54



# ANSI B 16.11

Reducing Hexagonal Nipples  
3000 / 6000 Lbs

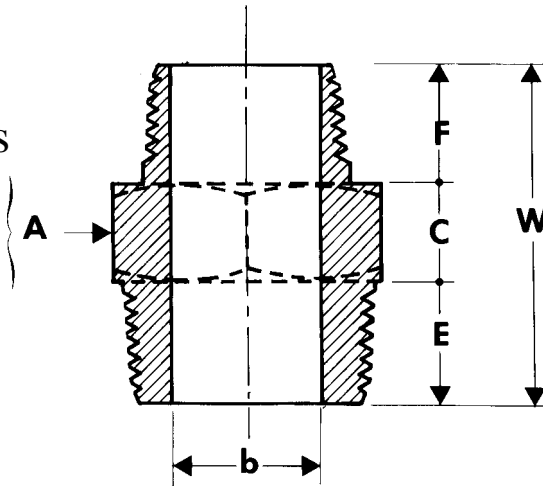

Nominal Size		A min.		E min.		F min.		C min.		W min.		B			
												3000		6000	
inches	mm	mm	inch	mm	inch	mm	inch	mm	inch	mm	inch	mm	inch	mm	inch
1/4x1/8	8x6	15	0.59	15	0.59	10	0.39	6	0.24	31	1.22	5	0.20	2	0.08
3/8x1/4	10x8	18	0.71	16	0.63	15	0.59	8	0.31	39	1.54	8	0.31	6	0.24
1/2x3/8	15x10	22	0.87	20	0.79	16	0.63	8	0.31	44	1.73	11	0.43	8	0.31
1/2x1/4	15x8	22	0.87	20	0.79	15	0.59	8	0.31	43	1.69	8	0.31	6	0.24
3/4x1/2	20x15	27	1.06	21	0.83	20	0.79	9	0.35	50	1.97	14	0.55	11	0.43
3/4x3/8	20x10	27	1.06	21	0.83	16	0.63	9	0.35	46	1.81	11	0.43	8	0.31
1x3/4	25x20	35	1.38	25	0.98	21	0.83	10	0.39	56	2.20	19	0.75	13	0.51
1x1/2	25x15	35	1.38	25	0.98	20	0.79	10	0.39	55	2.17	14	0.55	11	0.43
1.1/2x1	40x25	50	1.97	26	1.02	25	0.98	16	0.63	67	2.64	24	0.94	17	0.67
1.1/2x3/4	40x20	50	1.97	26	1.02	21	0.83	16	0.63	63	2.48	19	0.75	13	0.51
1.1/2x1/2	40x15	50	1.97	26	1.02	20	0.79	16	0.63	62	2.44	14	0.55	11	0.43
2x1.1/2	50x40	62	2.44	27	1.06	26	1.02	17	0.67	70	2.76	38	1.50	30	1.18
2x1	50x25	62	2.44	27	1.06	25	0.98	18	0.71	70	2.76	24	0.94	17	0.67
2x3/4	50x20	62	2.44	27	1.06	21	0.83	17	0.67	65	2.60	19	0.75	13	0.51
2x1/2	50x15	62	2.44	27	1.06	20	0.79	18	0.71	65	2.60	14	0.55	11	0.43